

120

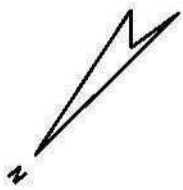

☐ OF BR.NO. 1288/1 AT KM 1288.605

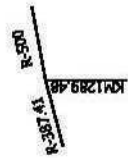

☐ OF BR.NO. 1284/7 AT KM 1287.885

☐ OF BR.NO. 1287/3 AT KM 1287.604

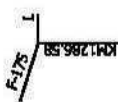

☐ OF RAGHOULI STATION BUILDING
'CROSSING STN.' AT KM 1288.215

MBA END

KURJ END

MEDIUM LEVEL P/F 354.00 X 15.30 M N.B.

ROAD

NORTH CENTRAL RAILWAY
 JHANSI DIVISION
 MAHOBA-KHAJURAHO SECTION
 DIAGRAM OF RAGHOULI
 STATION YARD

NOT TO SCALE
 DRG.NO.

31.03.2021

UP DATED UP TO